

CHASSIS

INSPECTION

1. INSPECT STEERING LINKAGE

- (a) Check the steering wheel freeplay (see page [SR-9](#)).
- (b) Check the steering linkage for looseness or damage.
 - Check that the tie rod ends do not have excessive play.
 - Check that the dust seals and boots are not damaged.
 - Check that the boot clamps are not loose.

2. INSPECT STEERING GEAR HOUSING OIL

Check the steering gear housing for oil leaks.

If leakage is found, check for cause and repair.

3. INSPECT BALL JOINTS AND DUST COVERS

- (a) Inspect the ball joints for excessive looseness.
- (b) Inspect the dust cover for damage.

4. 4WD:

INSPECT DRIVE SHAFT BOOTS

Inspect the drive shaft boots for loose clamps, grease leakage or damage.

5. CHECK OIL LEVEL IN MANUAL TRANSMISSION, TRANSFER AND DIFFERENTIAL

Remove the filler plug and feel inside the hole with your finger. Check that the oil comes to within 5 mm (0.20 in.) of the bottom edge of the hole.

If the level is low, add oil until it reaches the bottom of the fire hole.

Transmission oil: See page [MT-7](#).

Transfer oil: See page [TR-5](#).

Front differential oil (4WD): See page [SA-36](#).

Rear differential oil: See page [SA-101](#).

6. REPLACE MANUAL TRANSMISSION, TRANSFER AND DIFFERENTIAL OIL

- (a) Remove the drain plug and drain the oil.
- (b) Reinstall drain plug securely.
- (c) Add new oil until it reaches the bottom of the fire hole.

Transmission oil: See page [MT-7](#).

Transfer oil: See page [TR-5](#).

Front differential oil (4WD): See page [SA-36](#).

Rear differential oil: See page [SA-101](#).

7. CHECK FLUID LEVEL IN AUTOMATIC TRANSMISSION (See page [AT-4](#))

8. REPLACE AUTOMATIC TRANSMISSION FLUID

- (a) Remove the drain plug and drain the fluid.
- (b) Reinstall the drain plug securely.
- (c) Fill the transmission (See page [AT-4](#)).

9. LUBRICATE PROPELLER SHAFT AND TIGHTEN BOLTS

(a) 4WD:

Lubricate the propeller shaft, referring to the lubrication chart. Before pumping in grease, wipe off any mud and dust on the grease fitting.

Grease grade:

Propeller shaft (Except Double-cardan joint): Lithium base chassis grease NLGI No. 2

Double-cardan joint: Molybdenum disulphide lithium base chassis grease NLGI No. 2

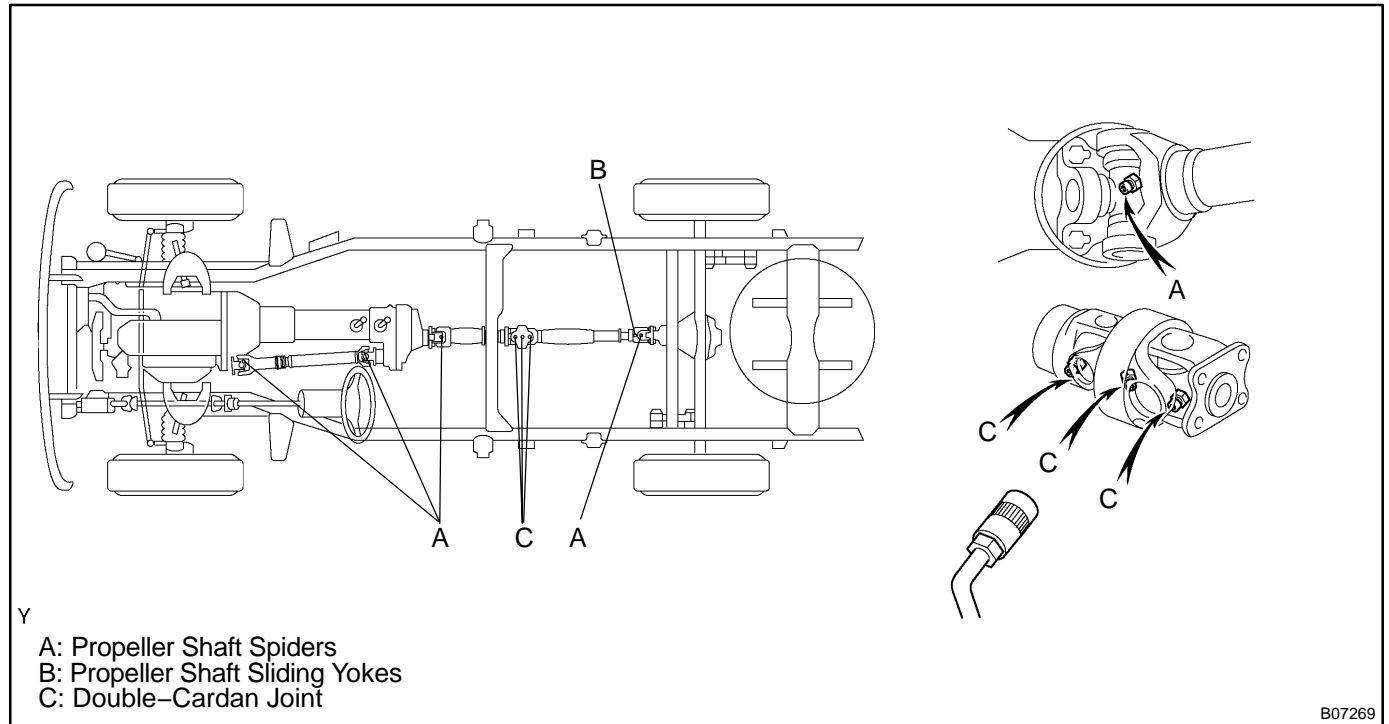

(b) Tighten the bolts for propeller shaft (2WD: See page [PR-8](#)) (4WD: See page [PR-15](#)).

10. ROTATE TIRES (See page [SA-3](#))